

frogDim1-3

Multifunktionell 1-kanals dimställdon för att dimma, tända och släcka belysning (110-240 V ~) och 3st ingång för kontroll av knappar och brytare. Bryt- och dimningsfunktion för all godkänd bakkantsfasstyrd dimningsbelysning. Framkantsfasstyrning endast godkänd för induktiv last. Med integrerad logikmodul med komfort- och timerfunktioner, effektmätning och kortslutningsdetektering (1x 300 W @ 230 V~).



Power supply

Inputs

Outputs

Gesamt-leistung

Logic module

Overcurrent detection

Backup

Power measurement

Timer functions

Dimming

Switching

VDE

Technical Data

Category	
Article designation	frogDim1-3
Article	D1-3-300.01
Assembly type	Recess-mounted (in device socket according to DIN 49073)

Functions and power	
Inputs 3	(AC 110–240 V ~)
Outputs 1	(AC 110–240 V ~)
Outputs dimmable	Yes (phase cutting or phase section control can be switched using the frogblue app; phase cutting is only permitted for inductive loads)
Minimum Load LED	LED 3 W
Maximum Power per output	300W/300VA (220-240V~) 150W/150VA (110-219V~)
Suitable loads	Light bulb load, electronic transformer, inductive load, (no motor load)
Output modes	dimming, switching
Protection category	Conforms to IP20
Integrated logic module	VDE Mark Certifications
Integrated configuration backup	Yes
Comfort and timer functions	Yes
Power measurement	Yes
Short circuit detection and notification	Yes

frogDim1-3

Dimensions and weight

Dimensions (L × B × H): 53 × 48 × 21 mm
Weight: 33 g

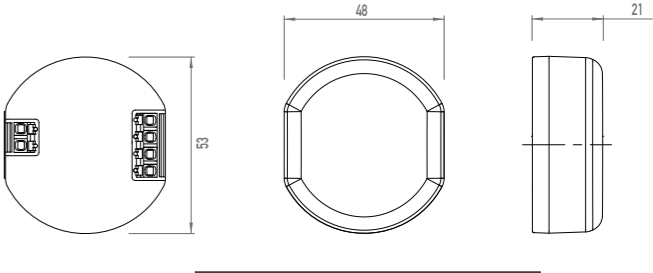

Connection example:

Socket depth min. 53 mm for installation behind switch insert
rec. 63 mm for installation behind switch insert

Individual installation is necessary for shallow depths.

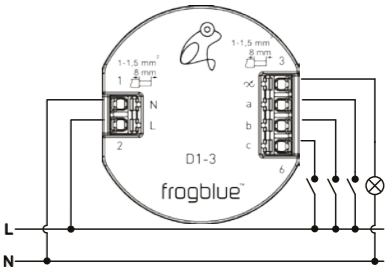

Electricity supply

Mains voltage	AC 110–240 V ~
Mains frequency	50 / 60 Hz
Stand-by consumption	< 220 mW

Network

WLAN	No
Bluetooth	Bluetooth 4.2 Low Energy
Frequency range	2400–2483.5 MHz maximum 3.4dBm
Typical radio open field range	30 metres

Operation and storage

Ambient temperature	25 ° to +55 °C
Storage temperature	-25 ° to +70 °C
Air humidity (during operation)	(Non-condensing)

Power connection

Contact type	ε, MOFSET
Connection variants	for bell, lamps, buttons, switches
Connection type	Spring-type terminal (single wire)
Wire cross section	1–1.5 mm² (rigid conductor recommended)
Stripping length	8 mm
Packaging size	1 unit
EAN 1 unit	4260578530026
Packaging dimensions (L × W × H) 1 unit	75 × 30 × 75 mm
Weight including packaging 1 unit	50 g
Air humidity (during operation)	(Non-condensing)

Note

A relay module (e.g. frogRelay2-2, frogRelay2-2-PF) must be utilised to control motor loads (e.g. roller shutter motor).

frogblue_Data_EN_1-21_D1-3-300.01 01.21

Subject to change.
Electrical equipment may be installed and fitted only by qualified electricians.

Further information
www.frogblue.com.

