

<b>Product name</b>	Optical Distribution Frame UHD 19" 1U 36xLCQ/SCD GRAY
<b>Product code</b>	5055295
<b>GTIN</b>	7332811377426
<b>ETIM-Class</b>	EC001130

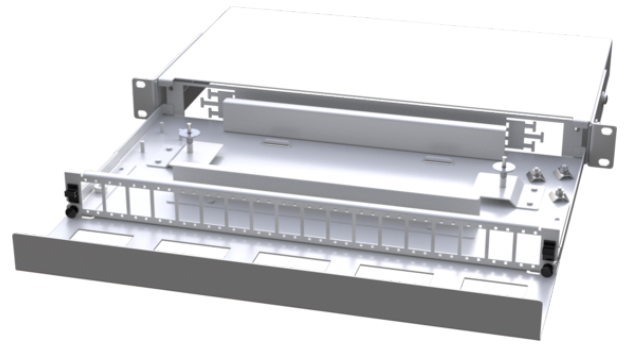

## PRODUCT SPECIFICATIONS

Fiber Optic Patch Panel Ultra High Density (UHD) 1U/2U. The patch panel is made of rugged alu-zinc metal and has a durable powder-coat finish coming in light gray color. The craft-friendly fiber optic trays and an integrated fiber storage allow comfortable assembly.

- Capacity up to 144 splices (1U version)
- Capacity up to 288 splices (2U version)
- Capacity up to 72×SC/144×LC connectors (1U version)
- Capacity up to 144×SC/288×LC connectors (2U version)
- Increased corrosion resistance (alu-zinc material)
- High connector density
- Removable patchcord support
- Depth adjustable 19" mounting brackets
- Removable Fiber Optic Trays to facilitate easy installation and maintenance
- Space for a fiber storage under the Fiber Optic Trays

## Measurements

<b>Length</b>	349 mm
<b>Height</b>	44 mm
<b>Width</b>	483 mm
<b>Weight</b>	4 400 g

## Technical Specifications - ODFs

<b>Fibre Count</b>	144
<b>Adapter Plate</b>	36xLC Quad/SC Duplex
<b>Preterminated</b>	No
<b>Sliding Enclosure</b>	Yes
<b>Mounting Type</b>	19" rack
<b>Number of Rack Spaces</b>	1 U
<b>Depth - ODF</b>	244 mm
<b>Depth - Front Shelf</b>	105 mm
<b>Colour</b>	Light Gray RAL 7035